

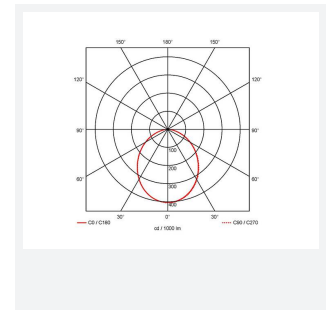

Galaxy

Galaxy CCT MultiLED Downlight Switch Dim Self-Code: AGALED/DD1/SM3

| | |
|---------------|-------------------------------------------------------------------|
| Category | Downlights |
| Application | Ancillary, Commercial, Education, Healthcare, Hospitality, Retail |
| Specification | Performance |

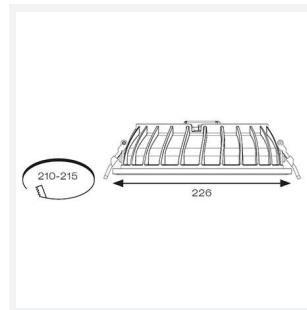
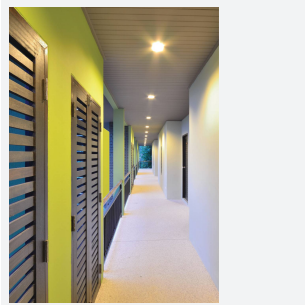

PRODUCT FEATURES

- Multi-wattage compact IP65 LED performance downlight suitable for education, commercial and healthcare applications
- Fitting and driver pre-wired with ST18 connectors
- Removable twist on, twist off bezel provides option of utilising alternative bezel and drop glass accessories
- Powered by Philips
- Cut-out dimensions suitable to replace most PLC downlights
- Faceted reflector and optical fresnel lens provides outstanding performance, uniformity and glare control
- Dimmable and Emergency options

| GENERAL INFORMATION | |
|---------------------|---------------------------|
| Wattage | 11W - 16W |
| Lumens Delivered | 1400lm - 2000lm (4000K) |
| Lm/W | 131lm/W - 125lm/W (4000K) |
| Beam Angle | 100 |
| CRI | 80 |
| CCT | 3000/4000K |
| Input | 220/240V |
| Operating Temp | 0°C - 35°C |
| SDCM | 5 |
| UGR | 24 |
| Cut-Out Size | 210mm |

| TECHNICAL INFORMATION | |
|--------------------------------|--------------|
| Light Source | LED |
| Colour / Finish | White |
| IP Rating | IP65 |
| Class Protection | 2 |
| Internal / External | Internal |
| Surface / Recessed / Suspended | Recessed |
| Lumen Depreciation | L70 100,000h |
| Warranty (Years) | 5 |
| CE Mark | Yes |
| Diameter | 226 mm |
| Height | 70 mm |

