



Lighting **excellence**



Antheia Solar

Antheia Solar Spike Light
Code: 4L2/6014

Application Garden

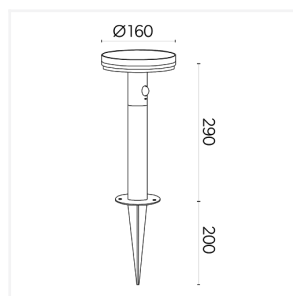
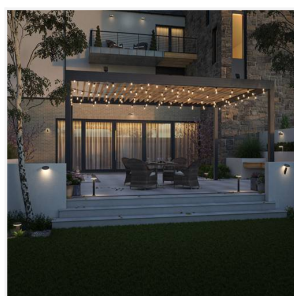

Product Features

- IP54 modern LED Solar Spike Lights. Made from a robust die-cast aluminum body and suitable for all year round use
- Free to run and no energy bills. Harnessing the sun's natural energy, the lights offer an impressive 10-12 hours of illumination
- Equipped with built in PIR motion sensor
- Co-ordinating bollards and wall lights available
- Flexible mounting options. Install into solid ground via the included screws or in soil and flower beds using the retractable spike accessory.
- Effortless installation, no wiring needed
- Enjoy a warm and cozy evening ambience with the included warm white LED bulbs.

Technical Information

Wattage	4W
Lumens Delivered	270lm
Lm/W	67lm/W
Beam Angle	180
CRI	80
CCT	3000K
Input	6V
Operating Temp	-20°C to 40°C
Product Weight without Packaging	0.627 kg

Technical Information

Light Source	LED
Colour / Finish	Anthracite
IP Rating	IP54
Class Protection	3
Internal / External	External
Mounting Option	In-ground
Warranty (Years)	4
CE Mark	Yes
Diameter	0 mm
Height	0 mm