

RAMSEY MARINE GRADE DUAL WATTAGE FLOOD LIGHT 6000K 200W/240W

NET-23-04-02

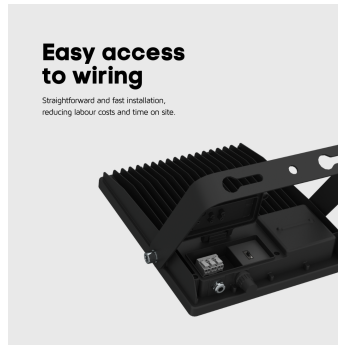

Features & Benefits

- Marine Grade coating protects the fitting from harsh weather and sea salt - ideal for coastal applications
- Choose between 200W or 240W at the time of installation
- IP66 and IK10 rated housing
- Optional 2-in-1 Motion and Photocell Sensor available

Key Data

Power	200W/240W
Luminous Flux	28000lm/33600lm
Colour Temperature	6000K
IP Rating	IP66
IK Rating	IK10
Dimensions	342 x 290 x 53mm
Warranty	5 Years (Registration Required)

Compatible Accessories

NET-42-04-39	2-in-1 Motion and Photocell Sensor for Ramsey Marine Grade Flood Lights
NET-51-04-59	Photocell Kit for Outdoor Lighting

NET LED Lighting

Buckingham Business Park, 300 Anderson Road,
 Swavesey, Cambridge, CB24 4UQ

T: 01223 851505 | sales@netled.co.uk | www.netled.co.uk



ORDER BY 6PM
 FOR NEXT DAY DELIVERY

Technical Specifications

Input Voltage (AC)	220-240V
Power Factor	0.95
Luminaire Efficacy	140lm/W
LED Manufacturer	Sanan
LED Type	SMD 3030
No. of LEDs	378
Driver Manufacturer	Tomcarline
Total Circuit Power (W)	200W/240W
Electrical Class	1
Colour Rendering	>70Ra
Lamp Viewing Angle	90°
Dimmable	No
Operating Temp.	-15°C to +50°C
Lifespan LM80	50,000 Hours
UGR Rating	27
Manufacturer	FYTLED Co. Ltd.
Fire Rating	V0
Power Frequency	50/60Hz
Housing Colour	Black
Housing Material	Aluminium Alloy
Diffuser Material	Polycarbonate

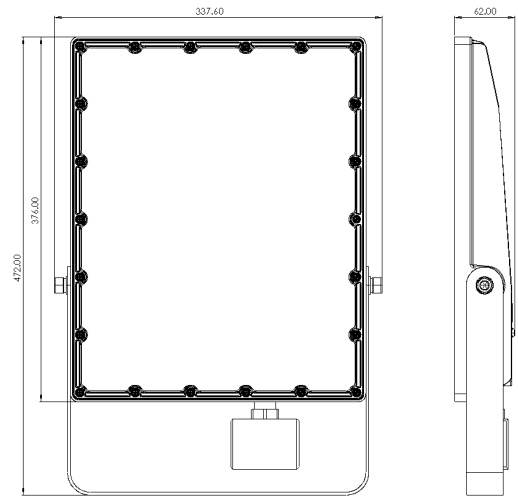

Other Options

Description	
NET-23-04-01	Ramsey Marine Grade Dual Wattage Flood Light 6000K 100W/150W
NET-23-04-02	Ramsey Marine Grade Dual Wattage Flood Light 6000K 200W/240W

NET LED Lighting

Buckingham Business Park, 300 Anderson Road,
Swavesey, Cambridge, CB24 4UQ



ORDER BY 6PM
FOR NEXT DAY DELIVERY

T: 01223 851505 | sales@netled.co.uk | www.netled.co.uk

MARINE GRADE COATING

Protect the flood light from harsh weather and sea salt – perfect for coastal applications

IP66 AND IK10 RATED HOUSING

Protected from moisture, dust and impact

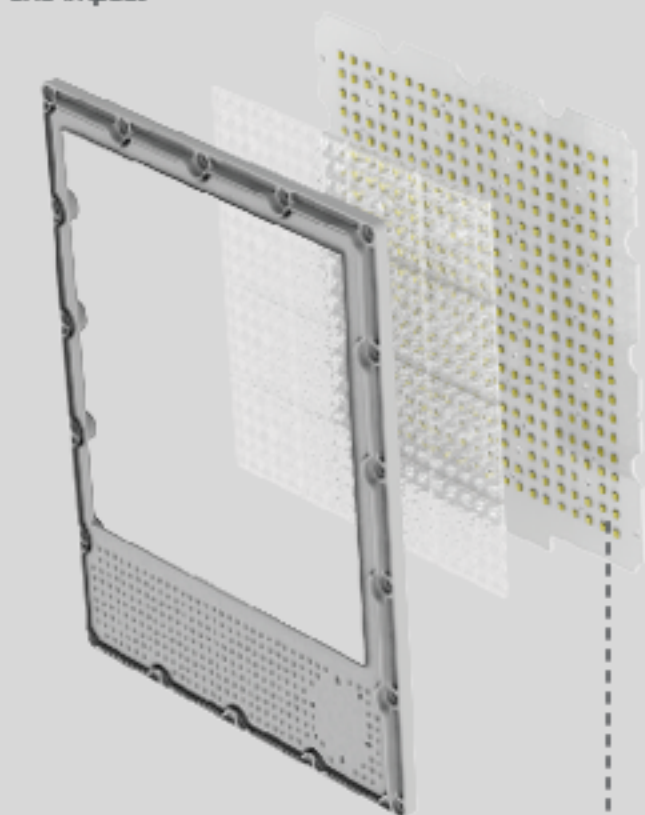

6K

6000K COLOUR TEMPERATURE

Bright and crisp light best used for industrial spaces

SELECTABLE POWER SETTING

Choose between 100W/150W or 200W/240W at the time of installation

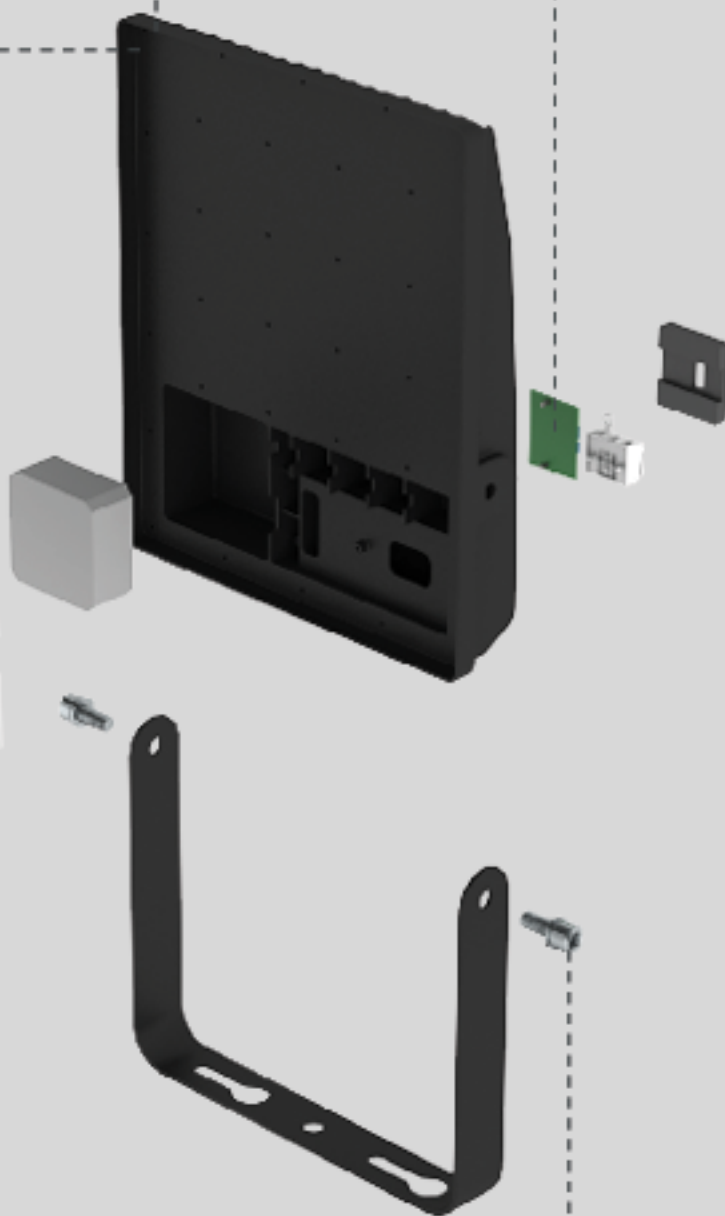

TOOL-FREE BOLTS

Set the angle of the flood light without the need for tools