

RAMSEY MARINE GRADE DUAL WATTAGE FLOOD LIGHT 6000K 100W/150W

NET-23-04-01

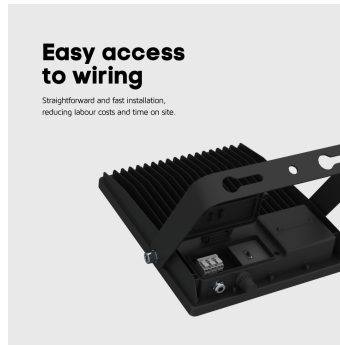

Features & Benefits

- Marine Grade coating protects the fitting from harsh weather and sea salt - ideal for coastal applications
- Choose between 100W or 150W at the time of installation
- IP66 and IK10 rated housing
- Optional 2-in-1 Motion and Photocell Sensor available

Key Data

Power	100W/150W
Luminous Flux	14000lm/21000lm
Colour Temperature	6000K
IP Rating	IP66
IK Rating	IK10
Dimensions	293 x 255 x 53mm
Warranty	5 Years (Registration Required)

Compatible Accessories

NET-42-04-39	2-in-1 Motion and Photocell Sensor for Ramsey Marine Grade Flood Lights
NET-51-04-59	Photocell Kit for Outdoor Lighting

NET LED Lighting

Buckingham Business Park, 300 Anderson Road,
Swavesey, Cambridge, CB24 4UQ

T: 01223 851505 | sales@netled.co.uk | www.netled.co.uk



ORDER BY 6PM
FOR NEXT DAY DELIVERY

Technical Specifications

Input Voltage (AC)	220-240V
Power Factor	0.95
Luminaire Efficacy	140lm/W
LED Manufacturer	Sanan
LED Type	SMD 3030
No. of LEDs	210
Driver Manufacturer	Tomcarline
Total Circuit Power (W)	100W/150W
Electrical Class	1
Colour Rendering	>70Ra
Lamp Viewing Angle	90°
Dimmable	No
Operating Temp.	-15°C to +50°C
Lifespan LM80	50,000 Hours
UGR Rating	27
Manufacturer	FYTLED Co. Ltd.
Fire Rating	V0
Power Frequency	50/60Hz
Housing Colour	Black
Housing Material	Aluminium Alloy
Diffuser Material	Polycarbonate

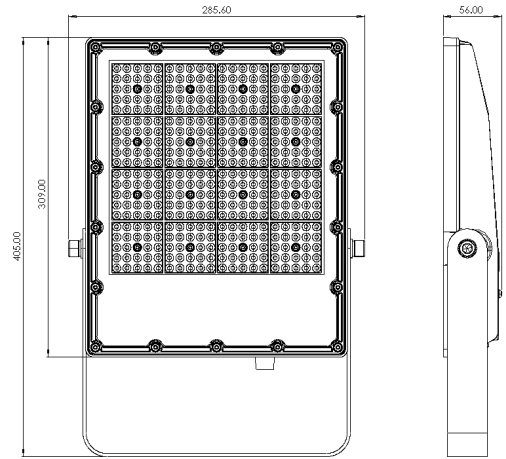

Other Options

Description	
NET-23-04-01	Ramsey Marine Grade Dual Wattage Flood Light 6000K 100W/150W
NET-23-04-02	Ramsey Marine Grade Dual Wattage Flood Light 6000K 200W/240W

NET LED Lighting

Buckingham Business Park, 300 Anderson Road,
Swavesey, Cambridge, CB24 4UQ



ORDER BY 6PM
FOR NEXT DAY DELIVERY

T: 01223 851505 | sales@netled.co.uk | www.netled.co.uk

MARINE GRADE COATING

Protect the flood light from harsh weather and sea salt – perfect for coastal applications

IP66 AND IK10 RATED HOUSING

Protected from moisture, dust and impact

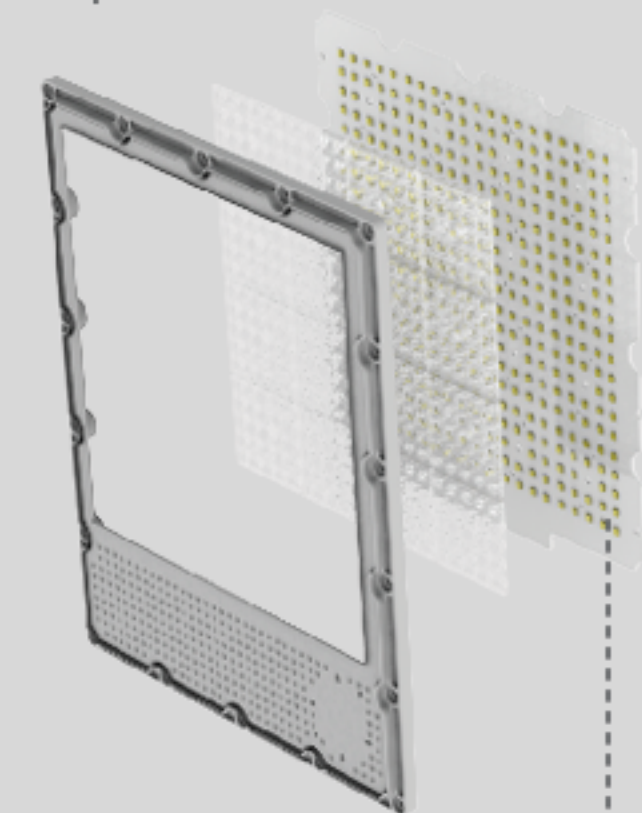

SELECTABLE POWER SETTING

Choose between 100W/150W or 200W/240W at the time of installation

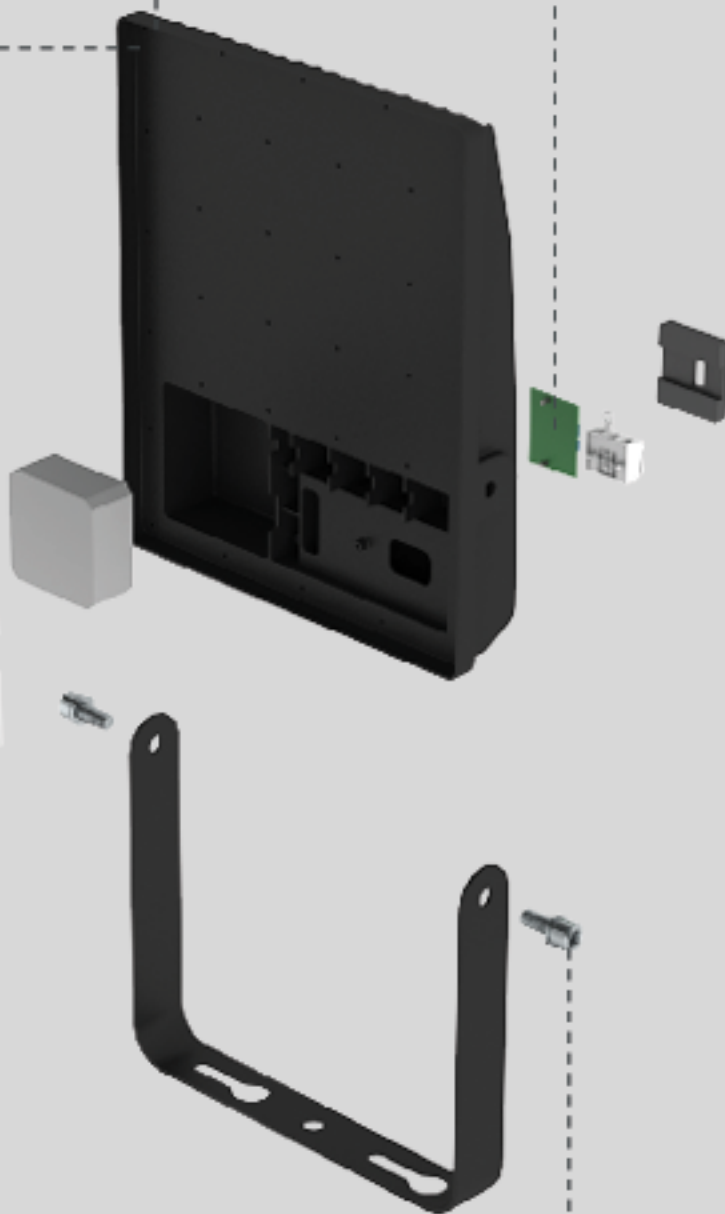

6K

6000K COLOUR TEMPERATURE

Bright and crisp light best used for industrial spaces

TOOL-FREE BOLTS

Set the angle of the flood light without the need for tools