

KALAMA LINEAR CHANDELIER

DLS16

Ivory Coconut Shell

H: 17 IN

W: 57 IN

D: 35.5 IN

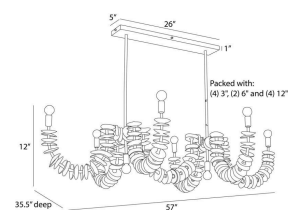

Both whimsical and natural, ivory coconut shell discs are strung on an ivory jute wrapped frame. Recalling the dramatic drape of a necklace, the directional strands hang airily from pipes of antique brass iron. A matching square canopy holds this dramatic fixture securely to the ceiling. Finish will vary.

CONTRACT: Suitable As Is