

WR-90 to SMA Female Right Angle Waveguide to Coax Adapters with UBR100 Flange, 8.2 - 12.4GHz

WR90/SMA-UBR100-K-V

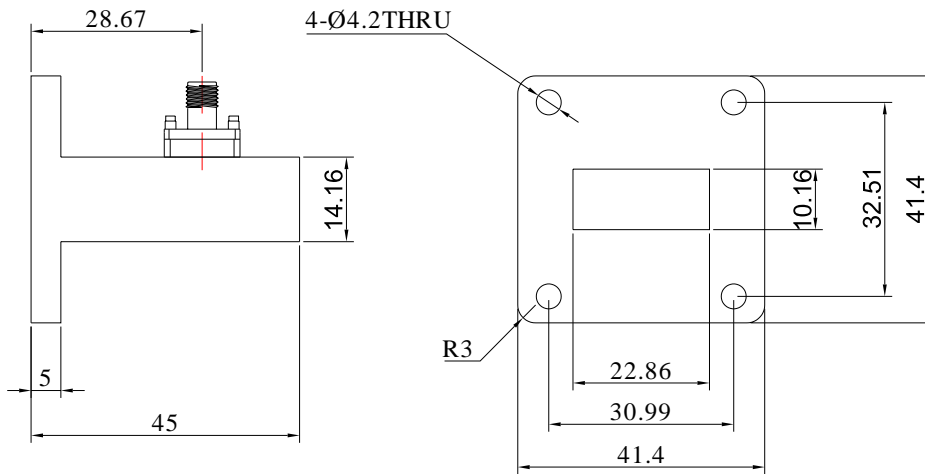

Dimensions are in mm

Product Configuration

| | |
|---------------------------|----------|
| Body Style | Straight |
| Flange Designation | UBR100 |
| Waveguide Size | WR-90 |
| Connector Series | SMA |
| Connector Polarity | Standard |
| Connector Gender | Female |
| Connector Impedance (Ohm) | 50 |

Electrical Specifications

| | |
|-----------------|-------------|
| VSWR | 1.25 |
| Insertion Loss | ≤0.25 |
| Frequency Range | 8.2-12.4GHz |

Mechanical Data

| | |
|---------------|----------|
| Weight (g) | 71.85 g |
| Body Material | Aluminum |

Environmental Specifications

| | |
|-----------------------------|------------------|
| RoHS Compliant | Yes |
| Operating Temperature Range | -30 °C to +70 °C |