

WR-75 to SMA Female Straight Waveguide to Coax Adapters with UBR120 Flange, 9.84 - 15GHz

WR75/SMA-UBR120-K-T

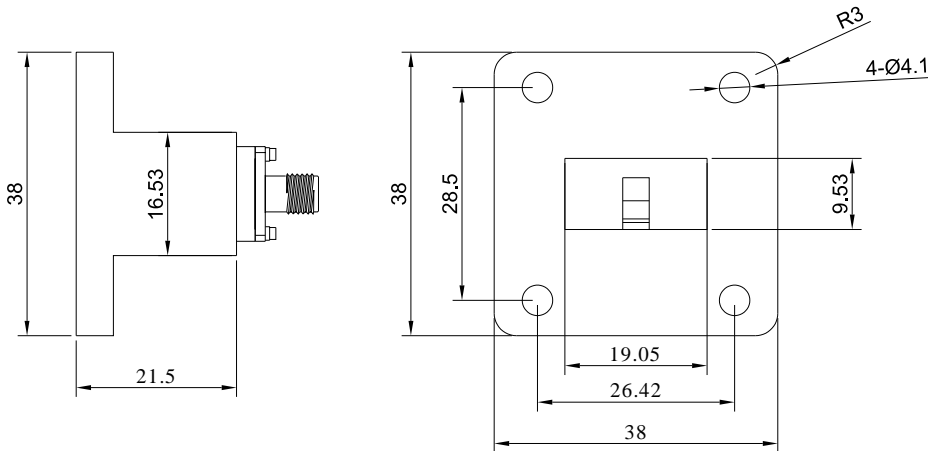

Dimensions are in mm

Product Configuration

| | |
|---------------------------|----------|
| Body Style | Straight |
| Flange Designation | UBR120 |
| Waveguide Size | WR-75 |
| Connector Series | SMA |
| Connector Polarity | Standard |
| Connector Gender | Female |
| Connector Impedance (Ohm) | 50 |

Electrical Specifications

| | |
|-----------------|------------|
| VSWR | 1.25 |
| Insertion Loss | ≤0.25 |
| Frequency Range | 9.84-15GHz |

Mechanical Data

| | |
|---------------|----------|
| Weight (g) | 38 g |
| Body Material | Aluminum |

Environmental Specifications

| | |
|-----------------------------|------------------|
| RoHS Compliant | Yes |
| Operating Temperature Range | -30 °C to +70 °C |