

**SMA Female Connector Vertical Launch Suit for PCB | Bulkhead Mount |
Length of Center Pin 0.9mm | DC - 12.4GHz**

P/N: FR2-SMA-KHD104-1

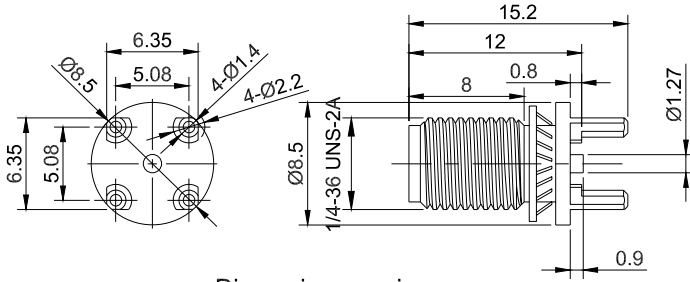

Dimensions are in mm



Product Configuration

Body Style	Straight
Connector Series	SMA
Connector Polarity	Standard
Connector Gender	Female
Termination Type	PCB
Connector Impedance (Ohm)	50
Mount Method	End Launch

Electrical Specifications

Frequency	DC - 12.4GHz
VSWR / Return Loss	≤1.2
Insertion Loss	≤ 0.03 x Sqrt.(f_GHz)

Mechanical Data

Min. Mating Cycles	≥500
Body Material	Brass
Body Plating	Gold

Environmental Specifications

RoHS Compliant	Yes
Operating Temperature Range	-45°C to +125°C