

SMA Female Panel Mount Connector | 2Hole Flange | Hole Spacing 8.9mm | Metal Feedthrough | Metal Core (4mm Dia x 4mm Length) | Round PCB Pin (0.8mm Dia x 2mm Length) | DC -26.5 GHz **SMA-KFD0601**

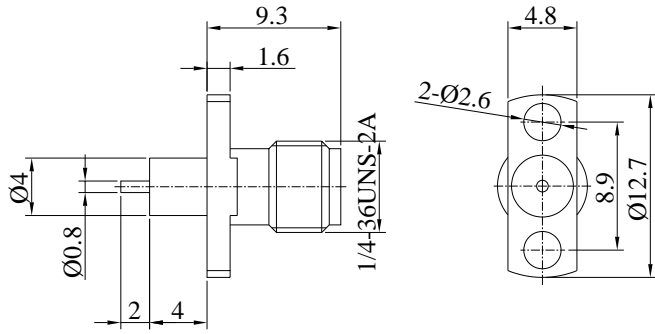

Dimensions are in mm



Product Configuration

Connector Series	SMA
Connector Polarity	Standard
Connector Gender	Female
Body Style	Straight
Termination Type	Field Replaceable Contact
Connector Impedance (Ohm)	50
Mount Method	2 Hole Flange

Mechanical Data

Min. Mating Cycles	≥500
Body Material	Stainless Steel
Body Plating	Passivated

Electrical Specifications

Frequency	DC - 26.5GHz
VSWR / Return Loss	1.15
Insertion Loss	≤ 0.1 x Sqrt.(f_GHz)

Environmental Specifications

RoHS Compliant	Yes
Operating Temperature Range	-55°C to +165°C
MIL/STD	N/A