

SMA Female Connector Field Replaceable with 4 Hole Flange | Hole Spacing 6.35mm | Acceptable Pin Diameter 0.30mm | DC-26.5GHz

P/N: FR2-SMA-KFD0230

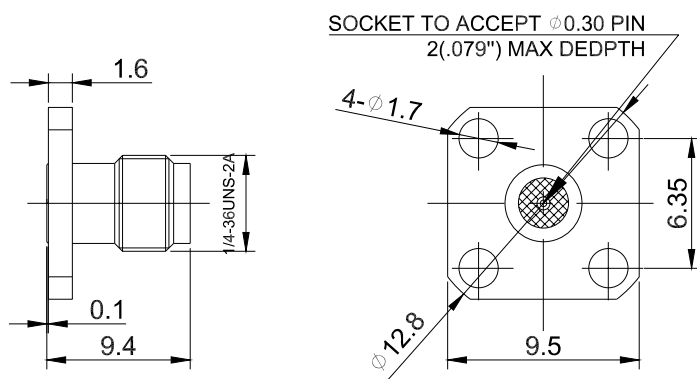

Dimensions are in mm



Product Configuration Cable

Body Style	Straight
Connector Series	SMA
Connector Polarity	Standard
Connector Gender	Female
Termination Type	Field Replaceable Contact
Connector Impedance (Ohm)	50
Mount Method	4 Hole Flange

Electrical Specifications

Frequency	DC - 26.5GHz
VSWR / Return Loss	≤ 1.15
Insertion Loss	$\leq 0.1 \times \text{Sqrt.}(f_GHz)$

Mechanical Data

Min. Mating Cycles	≥ 500
Body Material	Stainless Steel
Body Plating	Passivated

Enviromental Specifications

RoHS Compliant	Yes
Operating Temperature Range	-55 °C to +165 °C
MIL/STD	N/A