

SMA Female Connector Field Replaceable with 4 Hole Flange | Hole Spacing
6.35mm | Acceptable Pin Diameter 0.30mm | DC-26.5GHz

SMA-KFD0230

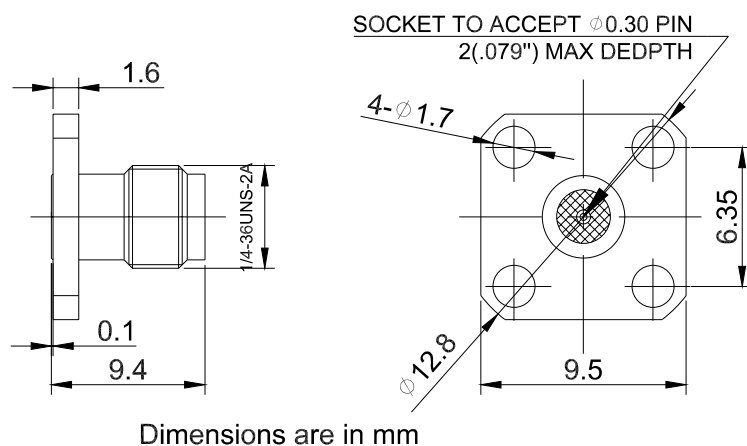

Product Configuration

Connector Series	SMA
Connector Polarity	Standard
Connector Gender	Female
Body Style	Straight
Termination Type	Field Replaceable Contact
Connector Impedance (Ohm)	50
Mount Method	4 Hole Flange

Mechanical Data

Min. Mating Cycles	≥ 500
Body Material	Stainless Steel
Body Plating	Passivated

Electrical Specifications

Frequency	DC - 26.5GHz
VSWR / Return Loss	≤ 1.15
Insertion Loss	$\leq 0.1 \times \text{Sqrt.}(f_GHz)$

Enviromental Specifications

RoHS Compliant	Yes
Operating Temperature Range	-55 °C to +165 °C
MIL/STD	N/A