

## SMA Female Connector for .047" Series Cable | 4 Holes Flange | DC-18GHz

P/N: FR2-SMA-KFB1

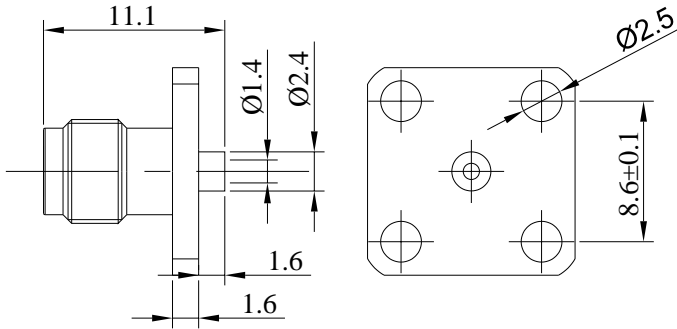

Dimensions are in mm



### Product Configuration

|                           |               |
|---------------------------|---------------|
| Body Style                | Straight      |
| Connector Series          | SMA           |
| Connector Polarity        | Standard      |
| Connector Gender          | Female        |
| Termination Type          | PCB           |
| Connector Impedance (Ohm) | 50            |
| Mount Method              | 4 Hole Flange |

### Electrical Specifications

|                    |                      |
|--------------------|----------------------|
| Frequency          | DC - 18GHz           |
| VSWR / Return Loss | 1.35 to 18 GHz       |
| Insertion Loss     | ≤ 0.1 x Sqrt.(f_GHz) |

### Mechanical Data

|                    |       |
|--------------------|-------|
| Min. Mating Cycles | ≥500  |
| Body Material      | Brass |
| Body Plating       | Gold  |

### Environmental Specifications

|                             |                 |
|-----------------------------|-----------------|
| RoHS Compliant              | Yes             |
| Operating Temperature Range | -40°C to +165°C |