

SMA Male Connector for .047" Series Cables, DC - 26.5GHz

P/N: FR2-SMA-JB1S

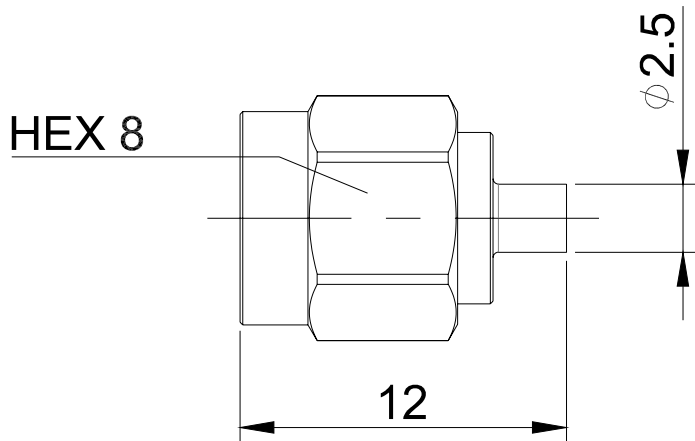

Dimensions are in mm

## Product Configuration

|                           |          |
|---------------------------|----------|
| Body Style                | Straight |
| Connector Series          | SMA      |
| Connector Polarity        | Standard |
| Connector Gender          | Male     |
| Termination Type          | Coax     |
| Connector Impedance (Ohm) | 50       |
| Mount Method              | None     |

## Electrical Specifications

|                |                                      |
|----------------|--------------------------------------|
| Frequency      | DC-18GHz                             |
| VSWR           | 1.35                                 |
| Insertion Loss | $< 0.1 \times \sqrt{f_{\text{GHz}}}$ |

## Mechanical Data

|                    |            |
|--------------------|------------|
| Min. Mating Cycles | $\geq 500$ |
| Weight             | 2.5 g      |
| Body Material      | Brass      |
| Body Plating       | Gold       |

## Environmental Specifications

|                             |                   |
|-----------------------------|-------------------|
| RoHS Compliant              | Yes               |
| Operating Temperature Range | -55 °C to +165 °C |
| MIL/STD                     | N/A               |