

N Female to SMA Female Adapter with 4 Hole Flange, DC - 18GHz

FR1-N/SMA-KFKS

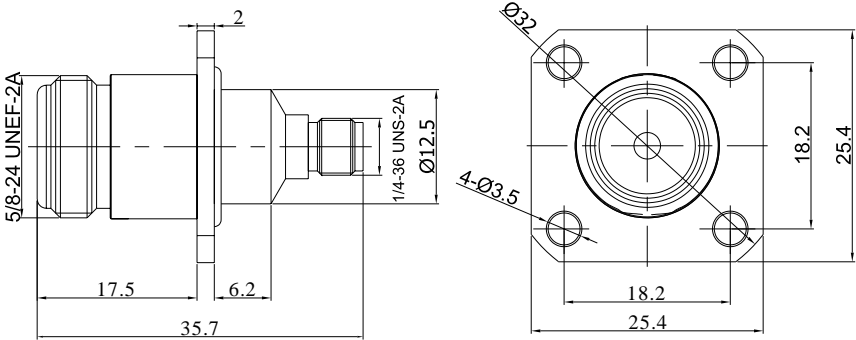

Dimensions are in mm



Product Configuration		Mechanical Data	
Connector 1 Series	N	Connector 1 Body Material	Stainless Steel
Connector 1 Polarity	Standard	Connector 1 Body Plating	Passivated
Connector 1 Gender	Female	Connector 2 Body Material	Stainless Steel
Connector 1 Impedance (Ohm)	50	Connector 2 Body Plating	Passivated
Connector 1 Mount Method	4 Hole Flange	Min. Mating Cycles	≥500
Connector 2 Series	SMA	Weight	41.8 g
Connector 2 Polarity	Standard		
Connector 2 Gender	Female		
Connector 2 Impedance (Ohm)	50		
Connector 2 Mount Method	4 Hole Flange		
Body Style	Straight		

Electrical Specifications		Enviromental Specifications	
Frequency	DC-18GHz	RoHS Compliant	Yes
VSWR	1.15	Operating Temperature Range	-55 °C to +165 °C
Insertion Loss	≤0.1 xSq.(f_GHz)	MIL/STD	N/A