

GPPO(Mini-SMP) Female RF Load Termination Up To 40 GHz, 1 Watts, Gold Plated Beryllium Copper

P/N: FR3-GPPO-K-03-4

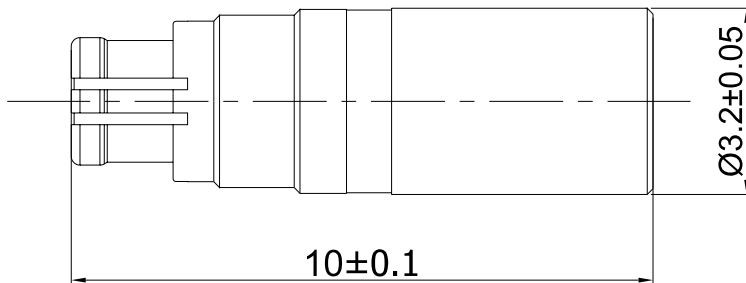

Dimensions are in mm

Product Configuration

Connector Series	GPPO(Mini-SMP)
Connector Polarity	Standard
Connector Gender	Female
Connector Impedance (Ohm)	50

Electrical Specifications

Frequency	DC- 40GHz
VSWR	1.2 to 18GHz, 1.4 to 40GHz
Power, Max Input (Watts)	1

Mechanical Data

Mating Cycles, Min	≥500
Body Material	Beryllium Copper
Body Plating	Gold
Cryogenic	No
Non-Magnetic	No

Environmental Specifications

RoHS Compliant	Yes
Operating Temperature Range	-55 °C to +125 °C
MIL/STD	N/A