

GPO(SMP) Female Connector PCB Mount Soldering, DC - 18GHz

P/N: FR2-GPO-KHD

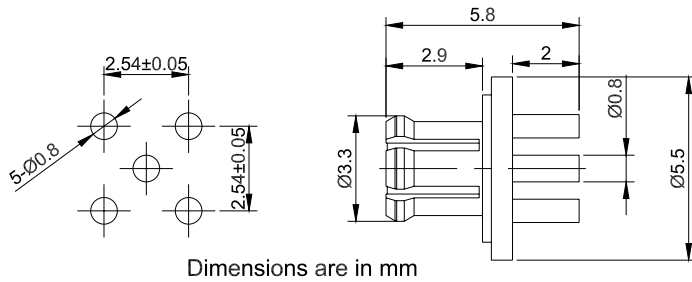

## Product Configuration

Body Style	Straight
Connector Series	GPO(SMP)
Connector Polarity	Standard
Connector Gender	Female
Termination Type	PCB
Connector Impedance (Ohm)	50
Mount Method	None

## Electrical Specifications

Frequency	DC-18GHz
VSWR	1.25
Insertion Loss	$\leq 0.1 \times \text{Sqrt.}(f\_GHz)$

## Mechanical Data

Mating Cycles, Min	$\geq 500$
Body Material	Beryllium Copper
Body Plating	Gold

## Environmental Specifications

RoHS Compliant	Yes
Operating Temperature Range	-55 °C to +165 °C
MIL/STD	Compliant