

GPO (SMP) Male Smooth Bore Connector PCB Mount Soldering | DC - 26.5GHz

GPO-JHD2-S

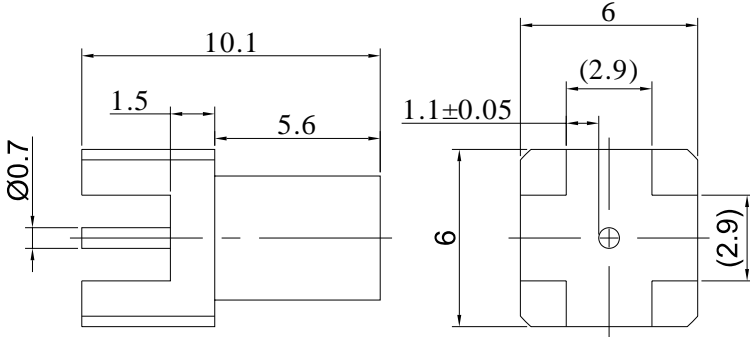

Dimensions are in mm

Product Configuration

Connector Series	GPPO(Mini-SMP)
Connector Polarity	Standard
Connector Gender	Male
Body Style	Straight
Termination Type	PCB
Connector Impedance (Ohm)	50
Mount Method	None

Mechanical Data

Min. Mating Cycles	≥ 500
Weight (g)	1.03 g
Body Material	Brass
Body Plating	Gold

Electrical Specifications

Frequency	DC - 26.5GHz
VSWR / Return Loss	1.43
Insertion Loss	$\leq 0.05 \times \text{Sqrt.}(f_GHz)$

Environmental Specifications

RoHS Compliant	Yes
Operating Temperature Range	-55 °C to +165 °C