

## GPO (SMP) Male Limited Detent Connector for PCB | DC - 26.5GHz

P/N: FR2-GPO-JHD1

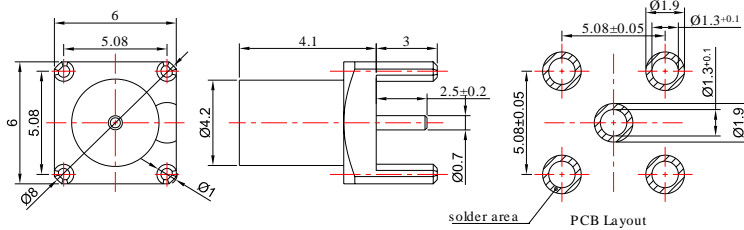

Dimensions are in mm



### Product Configuration

Body Style	Straight
Connector Series	GPO(SMP)
Connector Polarity	Standard
Connector Gender	Male
Termination Type	PCB
Connector Impedance (Ohm)	50
Mount Method	None

### Electrical Specifications

Frequency	DC - 26.5GHz
VSWR / Return Loss	1.43
Insertion Loss	$\leq 0.05 \times \text{Sqrt}(f\_GHz)$

### Mechanical Data

Min. Mating Cycles	$\geq 500$
Weight	0.5 g
Body Material	Brass
Body Plating	Gold

### Environmental Specifications

RoHS Compliant	Yes
Operating Temperature Range	-55 °C to +165 °C