

2-Way SMA Power Divider From 6 GHz to 18 GHz Rated at 20 Watts

P/N: GPD-2-060180-E

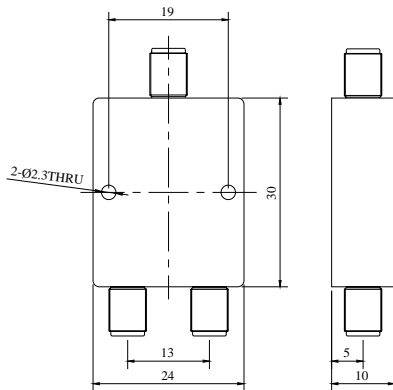

Dimensions are in mm



Product Configuration

Connector-In Series	SMA
Connector-In Polarity	Standard
Connector-In Gender	Female
Connector-In Impedance (Ohm)	50
Connector-Out Series	SMA
Connector-Out Polarity	Standard
Connector-Out Gender	Female
Connector-Out Impedance (Ohm)	50

Electrical Specifications

Insertion Loss	≤0.8
Power, Max Input (Watts)	20
VSWR, Max Input	1.3
Frequency Range	6-18GHz
VSWR, Max Output	1.3
Amplitude Balance (dB)	±0.3
Phase Balance (°)	±3
Isolation Min.(dB)	18

Mechanical Data

Min. Mating Cycles	≥500
Weight (g)	20.95 g
Colour	Black
Housing Material	Aluminum

2-Way SMA Power Divider From 6 GHz to 18 GHz Rated at 20 Watts

P/N: GPD-2-060180-E

Environmental Specifications

RoHS Compliant

Yes

Operating Temperature Range

-45 °C to +85 °C

Test Data

