

G3PO (SMPS) Male Connector Solder Attachment Surface Mount PCB | Vertical Launch | DC - 50GHz

G3PO-JHD1-S

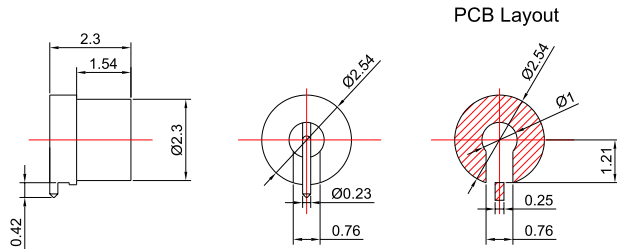

Dimensions are in mm



Product Configuration

Connector Series	G3PO(SMPS)
Connector Polarity	Standard
Connector Gender	Male
Body Style	Straight
Termination Type	PCB
Connector Impedance (Ohm)	50
Mount Method	None

Mechanical Data

Min. Mating Cycles	≥500
Body Material	Brass
Body Plating	Gold

Electrical Specifications

Frequency	DC - 50GHz
VSWR / Return Loss	14dB
Insertion Loss	≤ 0.1x Sqrt.(f_GHz)

Environmental Specifications

RoHS Compliant	Yes
Operating Temperature Range	-40°C to +155°C