

3.5mm Female to 3.5mm Female 4-Hole Flange Adaptors □ DC-26.5GHz

P/N: FR1-3.5-KFKS

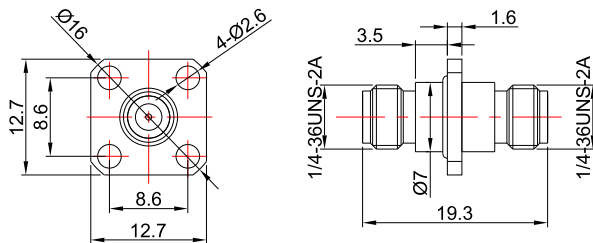

Dimensions are in mm



Product Configuration

	Connector 1	Connector 2
Connector Series	3.5mm	3.5mm
Connector Polarity	Standard	Standard
Connector Gender	Female	Female
Connector Impedance (Ohm)	50	50
Body Style	Straight	Straight
Connector Body Material	Stainless Steel	Stainless Steel
Connector Body Plating	Passivated	Passivated
Mount Method	4 Hole Flange	4 Hole Flange

Electrical Specifications

Frequency	DC - 26.5GHz
VSWR / Return Loss	1.15
Insertion Loss	$\leq 0.1 \times \text{Sqrt.}(f_GHz)$

Mechanical Data

Min. Mating Cycles	≥ 500
--------------------	------------

Environmental Specifications

RoHS Compliant	Yes
Operating Temperature Range	-55°C to +165°C