

2.92mm Male to GPPO (Mini-SMP) Male Adapter | DC - 40GHz

2.92/GPPO-JJ

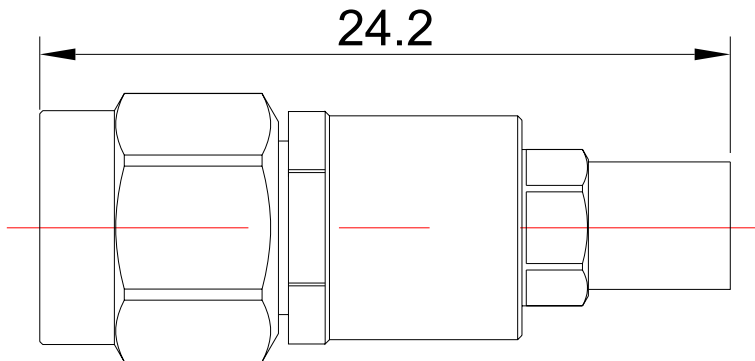

Dimensions are in mm

## Product Configuration

Connector 1 Series	2.92mm
Connector 1 Polarity	Standard
Connector 1 Gender	Male
Connector 1 Impedance (Ohm)	50
Connector 1 Mount Method	None
Connector 2 Series	GPPO(Mini-SMP)
Connector 2 Polarity	Standard
Connector 2 Gender	Male
Connector 2 Impedance (Ohm)	50
Connector 2 Mount Method	None

## Mechanical Data

Connector 1 Body Material	Stainless Steel
Connector 1 Body Plating	Passivated
Connector 2 Body Material	Stainless Steel
Connector 2 Body Plating	Passivated
Min. Mating Cycles	≥500
Weight (g)	5.7 g

## Electrical Specifications

Frequency	DC-40GHz
VSWR / Return Loss	1.25
Insertion Loss	≤0.05 xSqt.(f_GHz)

## Enviromental Specifications

RoHS Compliant	Yes
Operating Temperature Range	-55 °C to +165 °C
MIL/STD	N/A