

2.4mm Female Connector End Launch Suit for PCB Thickness 0.9mm,  
DC - 50GHz

P/N: FR2-2.4-KHD100

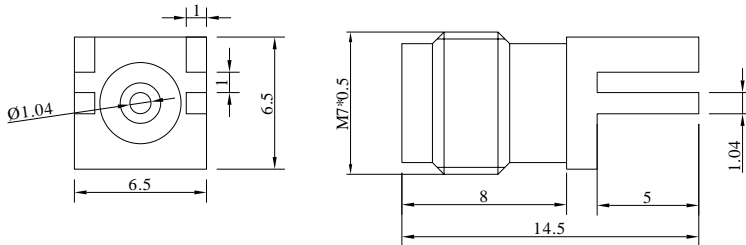

Dimensions are in mm



## Product Configuration

Body Style	Straight
Connector Series	2.4mm
Connector Polarity	Standard
Connector Gender	Female
Termination Type	PCB
Connector Impedance (Ohm)	50
Mount Method	End Launch

## Electrical Specifications

Frequency	DC-50GHz
VSWR	1.25
Insertion Loss	$\leq 0.05 \times \text{Sqrt.}(f\_GHz)$

## Mechanical Data

Min. Mating Cycles	$\geq 500$
Weight	2 g
Body Material	Brass
Body Plating	Gold

## Environmental Specifications

RoHS Compliant	Yes
Operating Temperature Range	-55 °C to +165 °C
MIL/STD	N/A