

2.4mm Female Solderless PCB Connector with 2 Hole Flange for CPW/Microstrip | **2.4-KFD216T**
DC - 50GHz | 6.35mm Slot

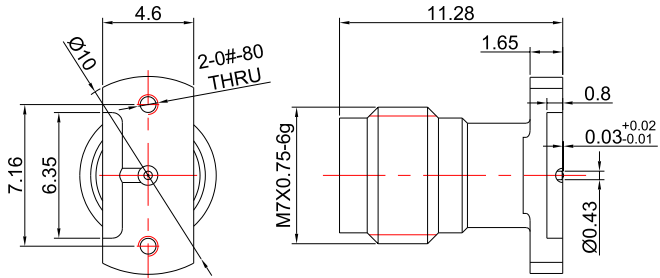

Dimensions are in mm

Product Configuration

Connector Series	2.4mm
Connector Polarity	Standard
Connector Gender	Female
Body Style	Straight
Termination Type	PCB
Connector Impedance (Ohm)	50
Mount Method	2 Hole Flange

Mechanical Data

Min. Mating Cycles	≥500
Body Material	Stainless Steel
Body Plating	Passivated

Electrical Specifications

Frequency	DC - 50GHz
VSWR / Return Loss	1.35
Insertion Loss	≤ 0.05 x Sqrt.(f_GHz)

Environmental Specifications

RoHS Compliant	Yes
Operating Temperature Range	-40°C to +125°C