

## 2.4mm Male to GPPO (Mini-SMP) Female Adapter | DC - 50GHz

2.4/GPPO-JK

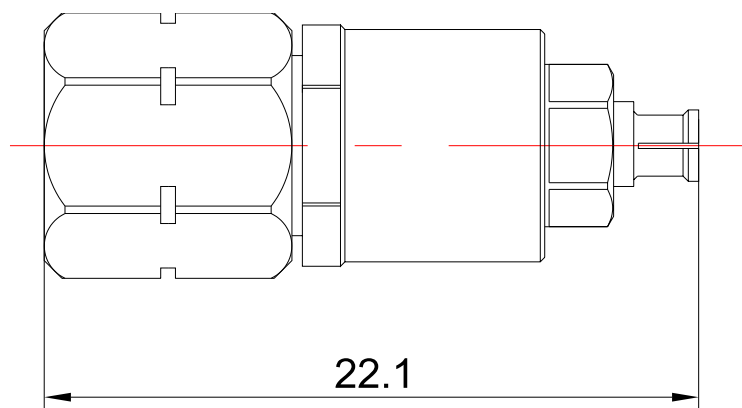

Dimensions are in mm

### Product Configuration

Connector 1 Series	2.4mm
Connector 1 Polarity	Standard
Connector 1 Gender	Male
Connector 1 Impedance (Ohm)	50
Connector 1 Mount Method	None
Connector 2 Series	GPPO(Mini-SMP)
Connector 2 Polarity	Standard
Connector 2 Gender	Female
Connector 2 Impedance (Ohm)	50
Connector 2 Mount Method	None

### Mechanical Data

Connector 1 Body Material	Stainless Steel
Connector 1 Body Plating	Passivated
Connector 2 Body Material	Beryllium Copper
Connector 2 Body Plating	Gold
Min. Mating Cycles	≥500
Weight (g)	5.3 g

### Electrical Specifications

Frequency	DC-50GHz
VSWR / Return Loss	1.25
Insertion Loss	≤0.05 xSqt.(f_GHz)

### Enviromental Specifications

RoHS Compliant	Yes
Operating Temperature Range	-55 °C to +165 °C
MIL/STD	N/A