

## 1.85mm Female Connector Solderless End Launch for PCB, DC - 65GHz

P/N: FR2-1.85-KFD0830

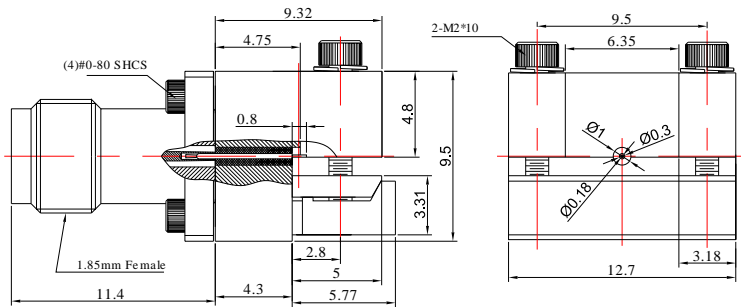

Dimensions are in mm



### Product Configuration

Body Style	Straight
Connector Series	1.85mm
Connector Polarity	Standard
Connector Gender	Female
Termination Type	PCB
Connector Impedance (Ohm)	50
Mount Method	End Launch

### Electrical Specifications

Frequency	DC-65GHz
VSWR	1.35
Insertion Loss	$\leq 0.05 \times \text{Sqrt.}(f\_GHz)$

### Mechanical Data

Mating Cycles, Min	$\geq 500$
Weight	9.9 g
Body Material	Brass
Body Plating	Tri-Metal

### Environmental Specifications

RoHS Compliant	Yes
Operating Temperature Range	-55 °C to +165 °C
MIL/STD	N/A