

## 1.85mm Male to G3PO(SMPS) Male Adapter | DC - 67GHz

1.85/G3PO-JJ

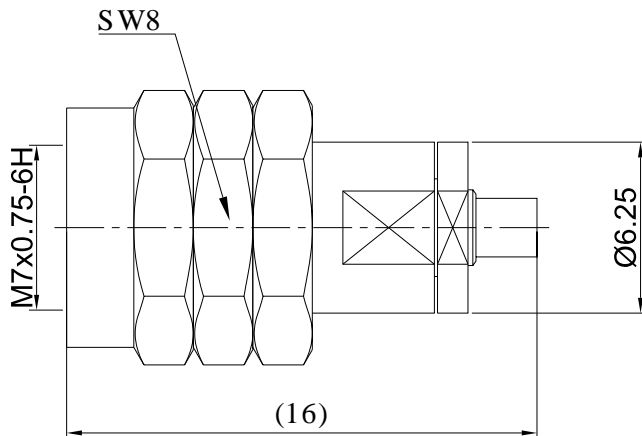

Dimensions are in mm



### Product Configuration

Connector 1 Series	1.85mm
Connector 1 Polarity	Standard
Connector 1 Gender	Male
Connector 1 Impedance (Ohm)	50
Connector 1 Mount Method	None
Connector 2 Series	G3PO(SMPS)
Connector 2 Polarity	Standard
Connector 2 Gender	Male
Connector 2 Impedance (Ohm)	50
Connector 2 Mount Method	None

### Mechanical Data

Connector 1 Body Material	Stainless Steel
Connector 1 Body Plating	Passivated
Connector 2 Body Material	Stainless Steel
Connector 2 Body Plating	Passivated
Min. Mating Cycles	≥500
Weight (g)	3.5 g

### Electrical Specifications

Frequency	DC-67GHz
VSWR / Return Loss	1.35
Insertion Loss	≤0.08 xSqt.(f_GHz)

### Enviromental Specifications

RoHS Compliant	Yes
Operating Temperature Range	-55 °C to +165 °C
MIL/STD	N/A