

1.0mm Female to 1.0mm Female Straight Precision Adapter | DC- 110GHz

P/N: 1.0-KKS

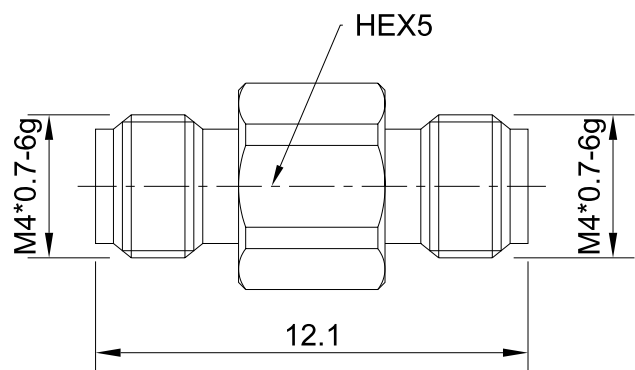

Dimensions are in mm

Product Configuration		
	Connector 1	Connector 2
Connector Series	1.0mm	1.0mm
Connector Polarity	Standard	Standard
Connector Gender	Female	Female
Connector Impedance (Ohm)	50	50
Connector Body Material	Stainless Steel	Stainless Steel
Connector Body Plating	Passivated	Passivated
Body Style	Straight	Straight

Electrical Specifications	
Frequency	DC - 110GHz
VSWR / Return Loss	1.4
Insertion Loss	≤ 0.06 x Sqrt.(f_GHz)

Mechanical Data	
Min. Mating Cycles	≥500
Weight (g)	1.3 g

Enviromental Specifications	
RoHS Compliant	Yes
Operating Temperature Range	-55 °C to +165 °C