

## 1.0mm Female to 0.8mm Female Straight Precision Adapter | DC to 110 GHz

P/N: FR1-1.0/0.8-KKS

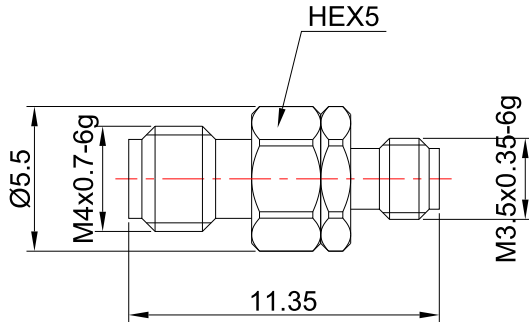

Dimensions are in mm



### Product Configuration

	Connector 1	Connector 2
Connector Series	1.0mm	0.8mm
Connector Polarity	Standard	Standard
Connector Gender	Female	Female
Connector Impedance (Ohm)	50	50
Body Style	Straight	Straight
Connector Body Material	Stainless Steel	Stainless Steel
Connector Body Plating	Passivated	Passivated

### Electrical Specifications

Frequency	DC - 110GHz
VSWR / Return Loss	1.35
Insertion Loss	$\leq 0.08 \times \text{Sqrt.}(f\_GHz)$

### Mechanical Data

Min. Mating Cycles	$\geq 500$
--------------------	------------

### Environmental Specifications

RoHS Compliant	Yes
Operating Temperature Range	-45°C to +125°C